

EXTRACTOR MODEL

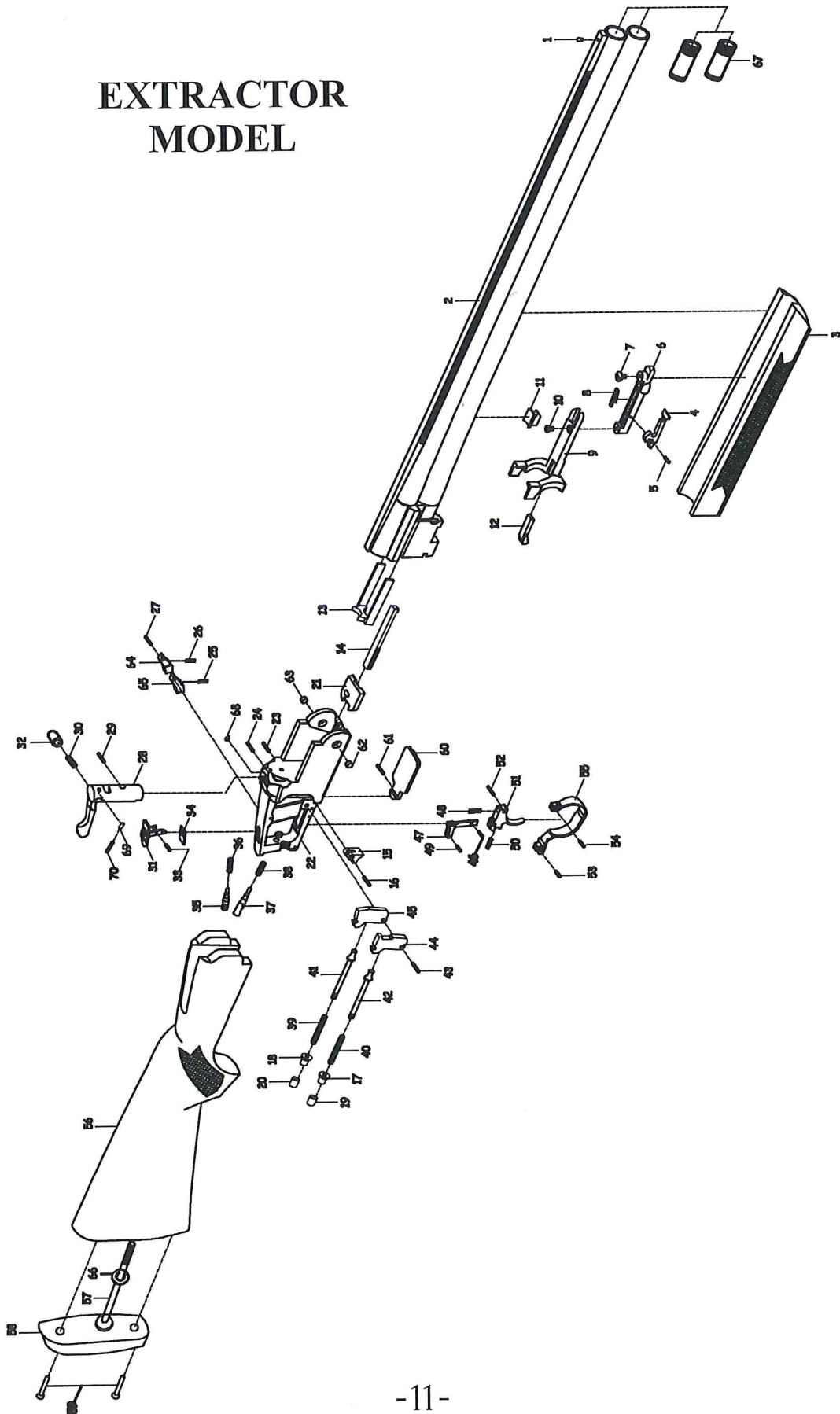

EXTRACTOR PARTS LIST

- | | |
|---------------------------------------|------------------------------------|
| 1 - Front Sight | 36 - Top Firing Pin Spring |
| 2 - Barrel | 37 - Bottom Firing Pin |
| 3 - Forearm | 38 - Bottom Firing Pin Spring |
| 4 - Forearm Latch | 39 - Hammer Spring (Left) |
| 5 - Forearm Latch Pin | 40 - Hammer Spring (Right) |
| 6 - Forearm Latch Frame | 41 - Left Hammer Spring Guide Rod |
| 7 - Forearm Latch Frame Screw | 42 - Right Hammer Spring Guide Rod |
| 8 - Forearm Latch Frame Spring | 43 - Hammer Pin |
| 9 - Forearm Iron | 44 - Hammer (Right) |
| 10 - Forearm Iron Screw | 45 - Hammer (Left) |
| 11 - Forearm Lug | 46 - Transfer Block Pin |
| 12 - Forearm Bolt | 47 - Transfer Block |
| 13 - Extractor | 48 - Trigger Spring |
| 14 - Cocking Rod | 49 - Selector Retaining Pin |
| 15 - Cocking Lever | 50 - Trigger Return Spring |
| 16 - Cocking Lever Pin | 51 - Trigger |
| 17 - Hammer Spring Pin Washer (Right) | 52 - Trigger Pin |
| 18 - Hammer Spring Pin Washer (Left) | 53 - Short Trigger Guard Pin |
| 19 - Hammer Spring Pin Nut (Right) | 54 - Long Trigger Pin |
| 20 - Hammer Spring Pin Nut (Left) | 55 - Trigger Guard |
| 21 - Blocker Plate | 56 - Stock |
| 22 - Receiver | 57 - Stock Bolt |
| 23 - Bottom Firing Pin Retaining Pin | 58 - Recoil Pad |
| 24 - Top Firing Pin Retaining Pin | 59 - Recoil Pad Screw |
| 25 - Rear Sear Spring | 60 - Receiver Bottom Plate |
| 26 - Left Sear Spring | 61 - Receiver Bottom Plate Pin |
| 27 - Sear Pin | 62 - Right Hinge Pin |
| 28 - Top Lever | 63 - Left Hinge Pin |
| 29 - Top Lever Pin | 64 - Left Sear |
| 30 - Top Lever Spring | 65 - Right Sear |
| 31 - Safety Selector | 66 - Stock Bolt Washer |
| 32 - Top Lever Spring Plunger | 67 - Choke |
| 33 - Safety Pin | 68 - Top Lever Detent Pin |
| 34 - Safety Spring | 69 - Top Lever Detent Pin Plunger |
| 35 - Top Firing Pin | 70 - Top Lever Detent Pin Spring |